

Horse Stable - Systems

Active Horse Systems

Box Feeding

www.active-horse.com



SCHAUER 

ACTIVE HORSE SYSTEMS



Table of Contents

innovativ und
artgerecht

BOX FEEDING SYSTEMS FOR HORSES

Roughage and concentrated feed supply

The importance of administrating many small amounts of roughage, as recommended by scientists, is still underestimated in box feeding. Set yourself apart with your farm and make this essential feeding method possible and even reduce your workload by providing large bales:

- Individually configurable for each box
- Can provide many small meals over 24 hours
- Presentation of large bales reduces workload
- Natural feeding posture
- Calmer behaviour and less stress due to group feeding
- Flexible working hours

Benefit from our many years of experience!

**Schauer - your strong partner
for your success in the stable**

Box feeding – Programme

Box Feeding Programme – Overview	6-7
Box Feeding Programme – List of boxes	8-9
Box Feeding Programme – Daily Routine	10-11
Box Feeding Programme – Feeding Protocole	12-13

Box Feeding –Models

Box Feeding - Detailed Plans

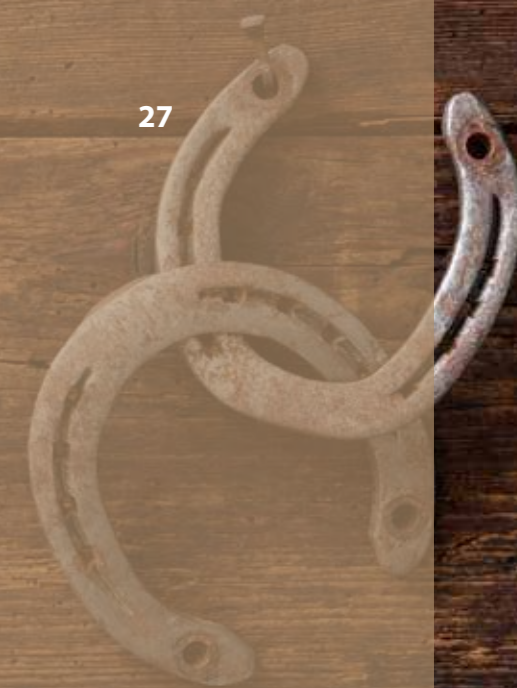



Box Feeding Programme - *Active Horse Systems*



www.active-horse.com

1

4

5



Box Feeding Programme - Overview

1

CompidentHorse **SCHALLER**

Boxen
Boxen: Automatik 65/65 - 43

Zubau 2/5 Neubau 0/10 Altstall1 18/20 Altstall2 0/30

Altstall1 Belegt: 18 / 20 Automatik aktiv

201 Carinoso	202 Dargo	203 Mojto	204 Ronja	205 Sinfonie	206 Sherade	207 Rambo	208 CinCin	209 Lucky Luke	210 Justin
211 Nejo	212 Atrévida	213 Wanja	214 Alaska	215 Bonita	216 Sava	217 —	218 Balthasar	219 —	220 Fly

201 Automatik Status Intervallzeit 13[x] Nächste Fütterung 16.00

Carinoso

Hau
Heutheut[] 0000
Aktuell[] 00

Hafer 1
Heutheut[] 20/1500
Aktuell[] 1,5

Mineralfutter
Heutheut[] 20/600
Aktuell[] 1,5

Tagesablauf für alle Herden anzeigen.

CompidentHorse 28.02.2023 14:59:04



The advantages are obvious



Clear division into stable areas



Easy functional overview



Details on each stall with one click



Box Feeding Programme - List of Boxes

2

Boxen Alstall 1 **SCHAUER** 20 / 65

Futter Dosiereinstellungen Parameter

Box	Stipp	Tier	Lagerbestand	Heu	Heu (kg)	Obst (kg)	Futter 1	Futter 2	Mineralfutter	Mineralfutter 2	Mineralfutter 3	Mineralfutter 4	Mineralfutter 5	Mineralfutter 6	Mineralfutter 7	Mineralfutter 8	Mineralfutter 9	Mineralfutter 10	
201	Camreno	Sommer	AbergüterHeu	300	300	0	Haler 1	1500	1500	0	Mineralfutter	800	800	0	0	0	0	0	0
202	Dango	Schulpferde	Heu	250	300	0	Müsi	1500	1500	0	Mineralfutter	800	800	0	0	0	0	0	0
203	Noglu	Sommer	AbergüterHeu	300	300	0	Haler 1	1500	1500	0	Mineralfutter	800	800	0	0	0	0	0	0
204	Ronia	Sommer	Heu	400	300	0	Haler 1	1500	1500	0	Haler 2	800	800	0	0	0	0	0	0
205	Silfonie	Sommer	Heu	300	300	0	Müsi	1500	1500	0	Mineralfutter	800	800	0	0	0	0	0	0
206	Shenade	Schulpferde	Heu	400	400	0	Haler 1	2000	2000	0	Mineralfutter	1100	1100	0	0	0	0	0	0
207	Rambis	Sommer	Heu	300	300	0	Haler 1	1500	1500	0	Mineralfutter	800	800	0	0	0	0	0	0
208	CanCan	Sommer	Heu	300	300	0	Haler 1	1500	1500	0	Haler 2	800	800	0	0	0	0	0	0
209	Lucky Luke	Schulpferde	Heu	400	400	0	Haler 1	2000	2000	0	Mineralfutter	1100	1100	0	0	0	0	0	0
210	Justin	Sommer	AbergüterHeu	300	300	0	Müsi	1500	1500	0	Mineralfutter	800	800	0	0	0	0	0	0
211	Nejo	Sommer	Heu	300	300	0	Haler 1	1500	1500	0	Mineralfutter	800	800	0	0	0	0	0	0
212	Abevida	Sommer	Heu	300	300	0	Haler 1	1500	1500	0	Mineralfutter	800	800	0	0	0	0	0	0
213	Wanja	Schulpferde	Heu	400	400	0	Haler 1	2000	2000	0	Mineralfutter	1100	1100	0	0	0	0	0	0
214	Alaska	Sommer	Heu	300	300	0	Haler 1	1500	1500	0	Haler 2	800	800	0	0	0	0	0	0
215	Bonita	Sommer	Heu	300	300	0	Müsi	1500	1500	0	Mineralfutter	800	800	0	0	0	0	0	0
216	Sara	Pensionisten	Heu	400	400	0	Haler 1	2000	2000	0	Mineralfutter	1100	1100	0	0	0	0	0	0
217	----	Pensionisten	----	0	0	0	----	0	0	0	----	0	0	0	0	0	0	0	0
218	Ballhasar	Sommer	Heu	400	400	0	Haler 1	2000	2000	0	Mineralfutter	1100	1100	0	0	0	0	0	0
219	----	Pensionisten	----	0	0	0	----	0	0	0	----	0	0	0	0	0	0	0	0
220	Fly	Sommer	Heu	300	300	0	Haler 1	1500	1500	0	Mineralfutter	800	800	0	0	0	0	0	0

Alle Tiere anzeigen

CompidentHorse 01.03.2023 07:04:16



The advantages are obvious



Overview of daily quantities and consumption



Simple adjustments to daily routine



Individual control for additional feeding



Box Feeding Programme - *Daily Routine*

3

Tagesablauf Automatik aktiv

Boxen

Tagesabläufe	Tagesablauf: Sommer			Zugeordnete Tiere		Nicht zugeordnete Tiere		
Bezeichnung	Startzeit	Haarfüller%	Füller%	Titel	Box	Titelname	Tagesablauf	Box
Pensionisten	00:15	20	0	Alaska	214	Algan	Pensionisten	---
Schulpferde	04:00	10	0	Abevida	212	Bounty	Pensionisten	T
Sommer	05:00	0	20	Ayla	2	Clio	Pensionisten	---
Winter	07:00	20	0	Balthasar	218	Commandante	Schulpferde	---
	08:00	0	20	Borisa	215	Convensano	Pensionisten	---
	10:00	10	0	Carinos	201	Critchen	Pensionisten	---
	11:00	0	20	CieCie	208	Dage	Schulpferde	202
	13:00	10	0	Fly	220	Diamona	Pensionisten	---
	14:00	0	20	Judith	210	Duce	Pensionisten	---
	16:00	10	0	Majo	203	Esony	Pensionisten	---
	17:00	0	20	Nego	211	Felix_Box	Pensionisten	---
	19:00	10	0	Rando	207	Fank	Pensionisten	---
	22:00	10	0	Ronga	204	Geary	Pensionisten	---
				Sentune	205	Goldylei	Pensionisten	---
						Grina	Pensionisten	---
						Gwendolin	Pensionisten	---
						Hape	Pensionisten	---
						Henry	Pensionisten	---
						Hope	Pensionisten	---
						Inéz	Pensionisten	---
						Johanna	Pensionisten	---
						Lex	Pensionisten	---
						Lily	Pensionisten	---
						Lionel	Pensionisten	---
						Livia2	Pensionisten	---
						Lucky Luke	Schulpferde	209
						Lul	Pensionisten	---
						Lul	Pensionisten	---
						MagicPoint	Pensionisten	---
						Mighty Heart	Pensionisten	---
						Moriko	Pensionisten	---

CompidentHorse 01.03.2023 07:18:37



The advantages are obvious



Unlimited number of individual daily routines



If the animal is not in the box, the feed does not lapse, but is divided evenly over the rest of the day



4

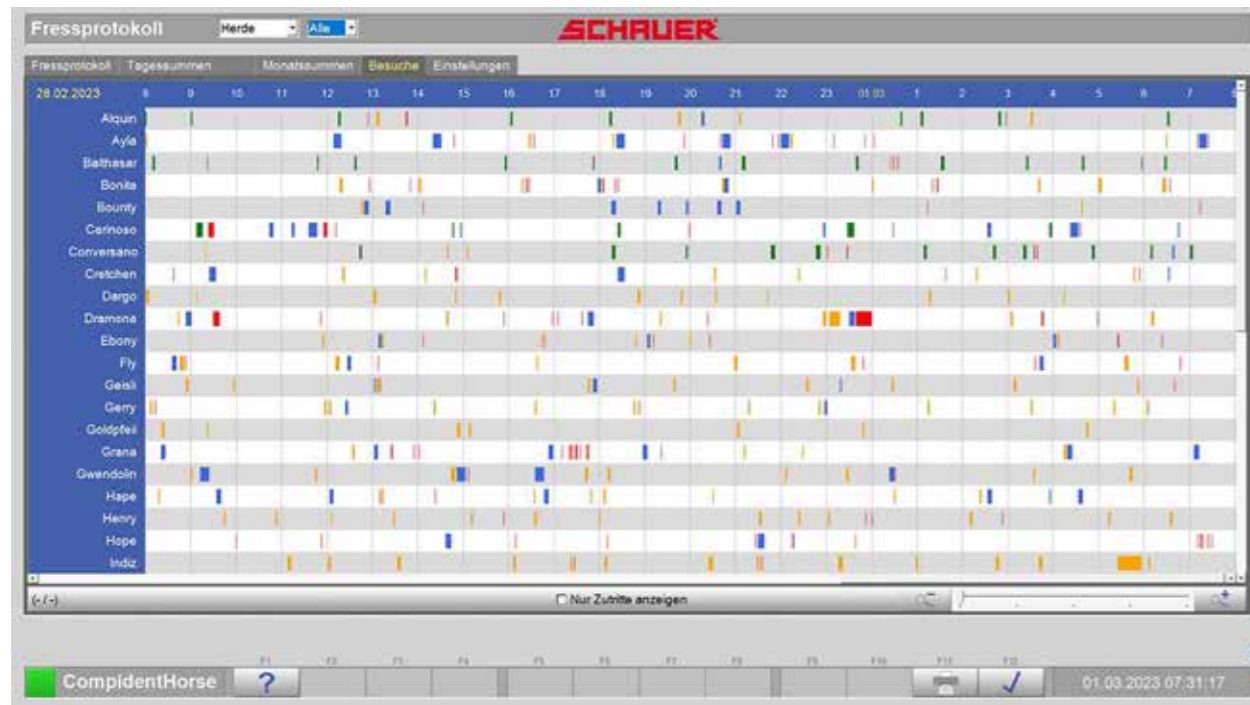

Box Feeding Programme - *Feed Protocol*

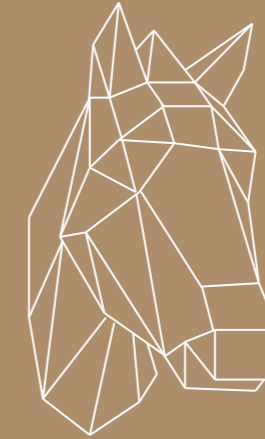

The advantages are obvious



Recording of feeding times as log and as graph



Optional monitoring of drinking behaviour



Box Feeding Programme - *Version 1 and 2*

1

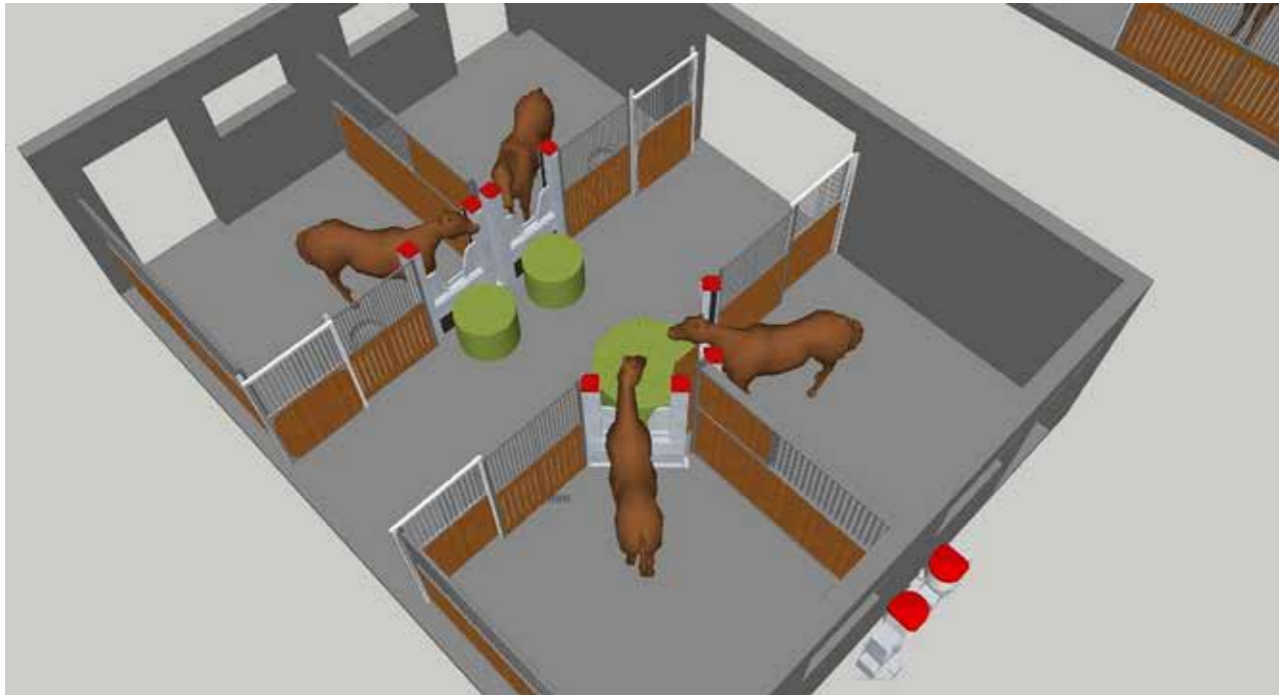

2

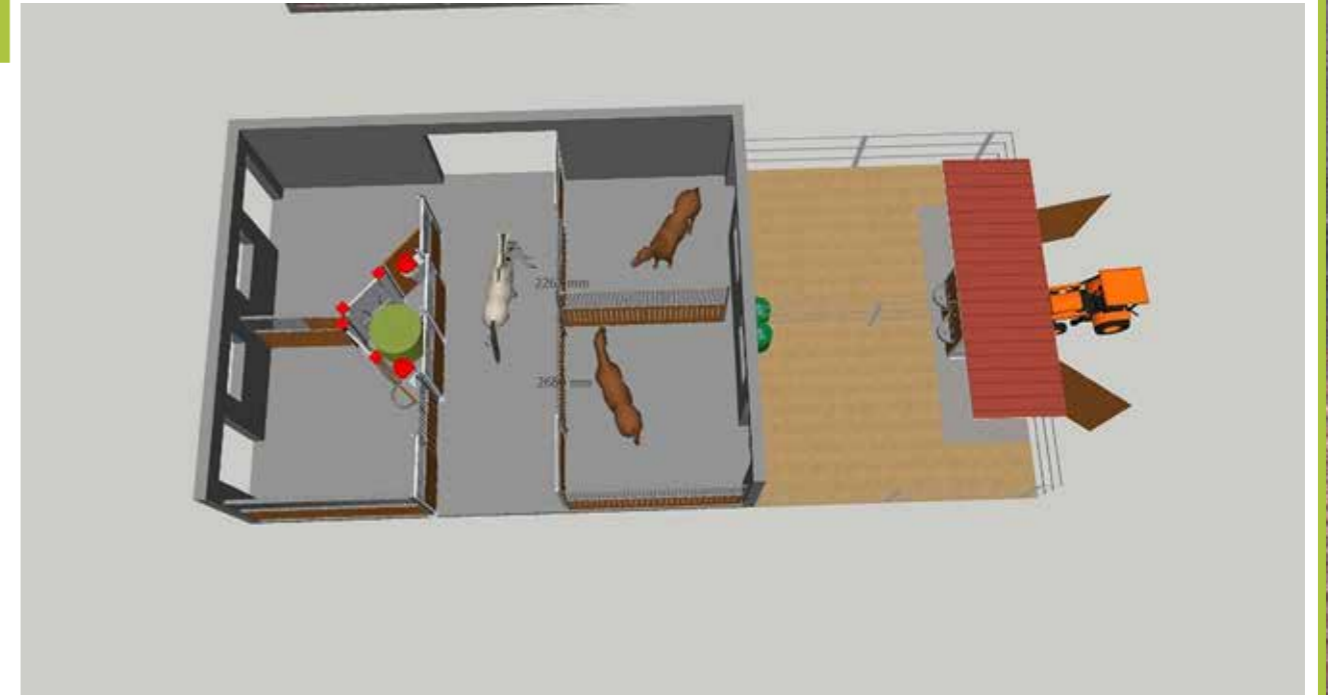



Box Feeding Programme - *Version 2a and 2b*

2a



2b

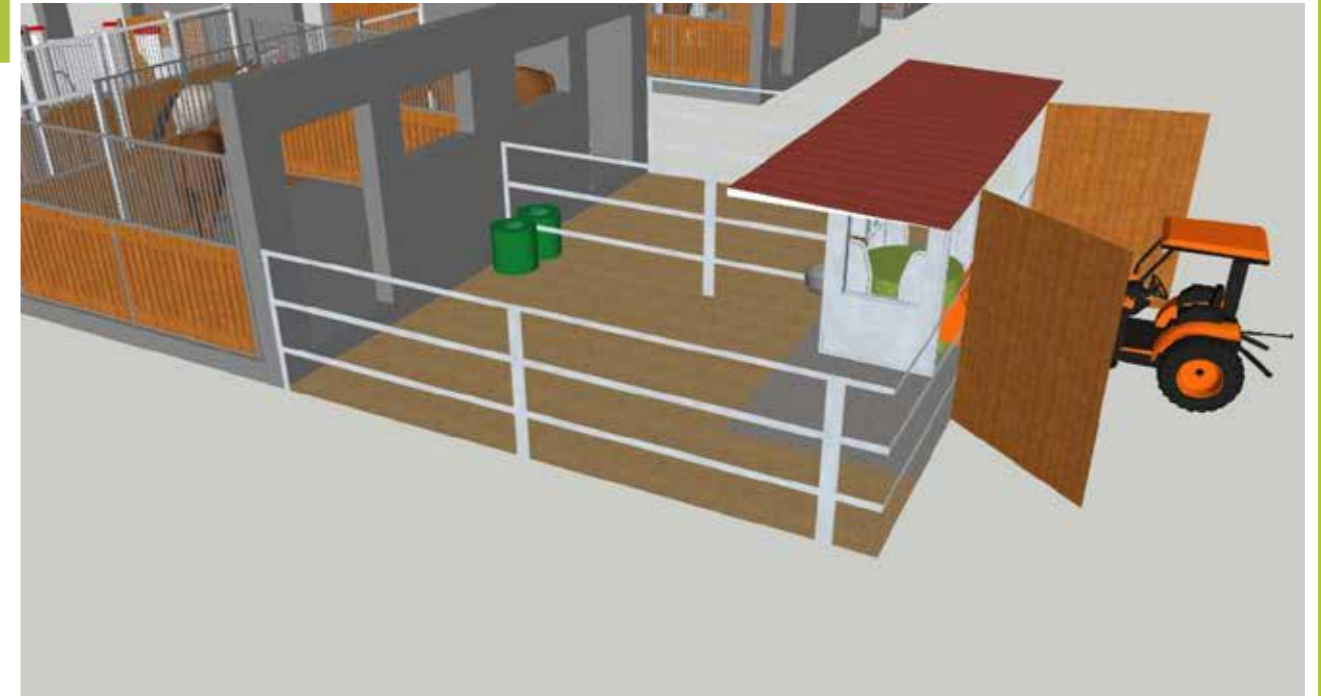



Box Feeding Programme - *Version 3 and 3a*

3



3a

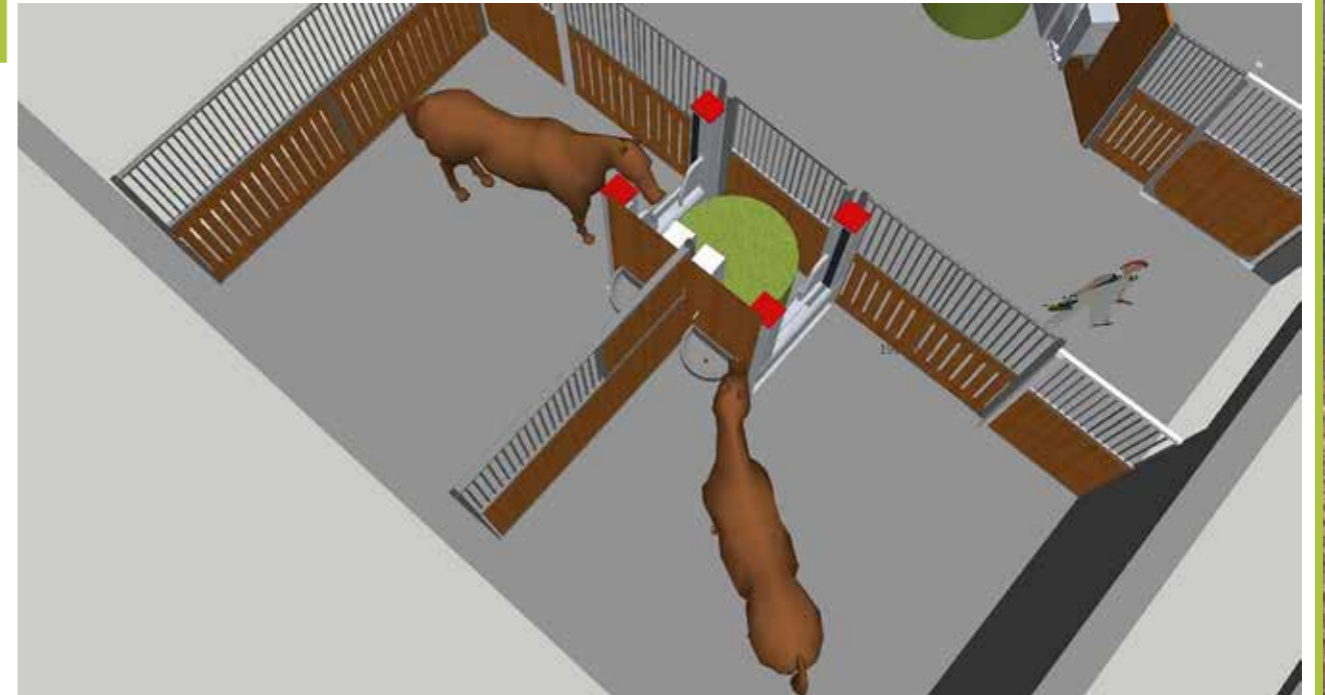



Box Feeding Programme - *Version 4 and 4a*

4



4a





Box Feeding Programme - *Version 5 and 5a*

5



5a





Box Feeding Programme - *Version 5b and 5c*

5b



5c





Box Feeding Programme - Version 5d

5d



Box Feeding Programme - Detailed Plans

Box:
ca. 3,50m
x
4,0m

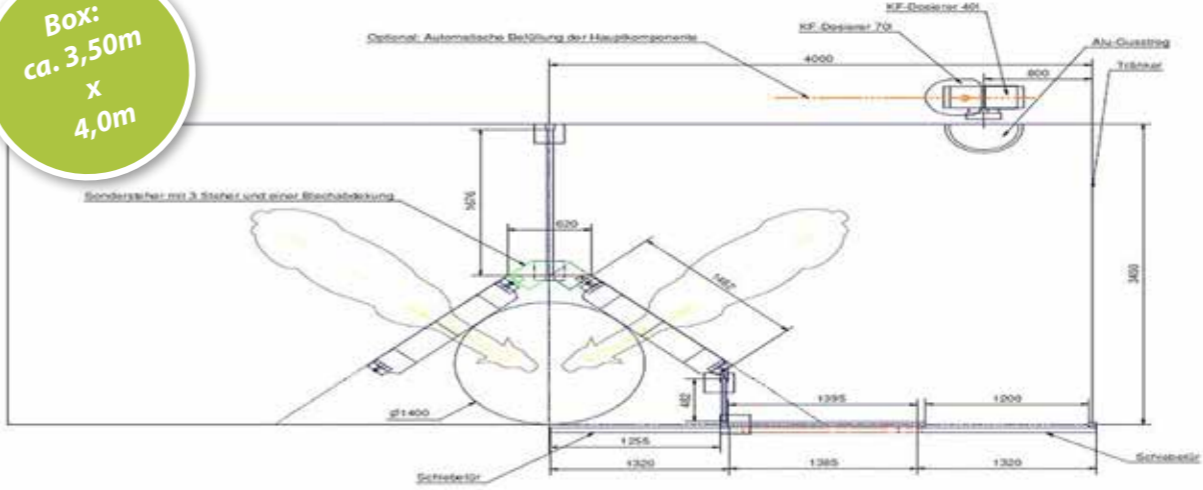

Box:
ca. 4,0m
x
3,35m

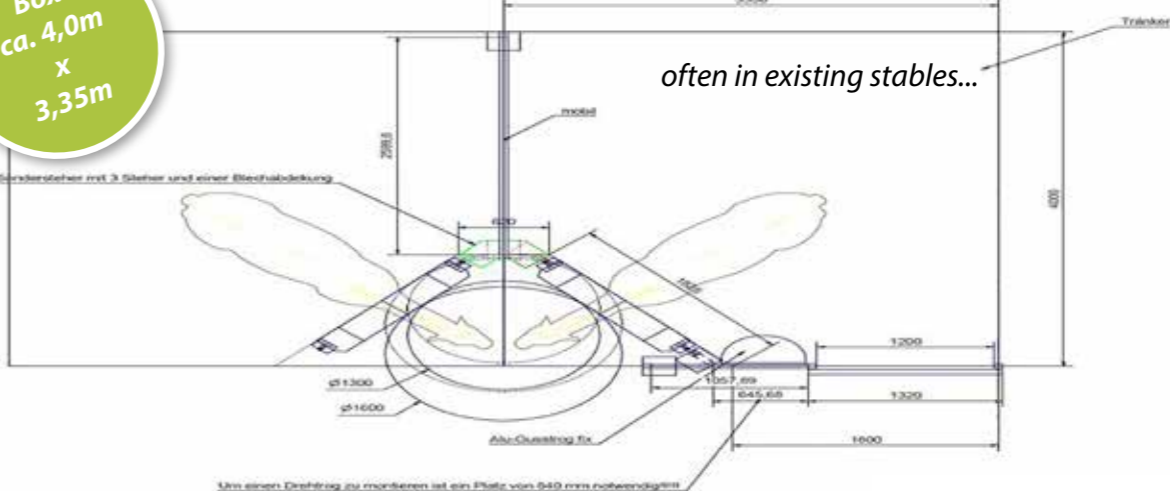

Your partner for keeping horses

To meet the high demands
of owners and horses, we rely on the
professional advice of our experienced staff.

Schauer Agrotronic GmbH

A-4731 Prambachkirchen, Passauer Str. 1
Tel. +43/72 77/23 26-0
office@schauer-agrotronic.com

Schauer Maschinenfabrik GmbH

Vertriebsgesellschaft
D-94060 Pocking, Gewerbering 19
Tel. +49/85 31/82 72
germany@schauer-agrotronic.com

Schauer Agrotronic AG

CH-6247 Schötz, Sentmatte 4
Tel. +41/41/926 80 00
office@schauer.ch

office@schauer-agrotronic.com
www.active-horse.com

facebook.com/schaueractivehorse

